

### FEATURES

- Ideal for printed circuit board
- Reliable low cost construction utilizing molded plastic technique
- Plastic material has U/L flammability classification 94V-0
- Mounting position: Any

### Maximum Ratings (@TA = 25°C unless otherwise specified)

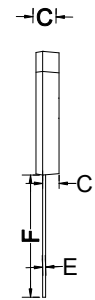
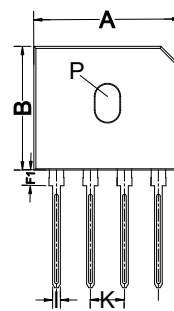

GBU		
Dim	Min	Max
A	21.60	22.40
B	18.20	19.80
C	3.20	3.80
C1	1.80	2.80
E	0.40	0.60
F	17.00min	
F1	1.70	2.40
I	0.95	1.25
K	4.70	5.30
P	R1.9typical	
All Dimensions in mm.		

Characteristic	Symbol	GBU25A	GBU25B	GBU25D	GBU25G	GBU25J	GBU25K	GBU25M	UNITS
Maximum recurrent peak reverse voltage	$V_{RRM}$	50	100	200	400	600	800	1000	V
Maximum RMS voltage	$V_{RMS}$	35	70	140	280	420	560	700	V
Maximum DC blocking voltage	$V_{DC}$	50	100	200	400	600	800	1000	V
Maximum average forward Output current @T <sub>c</sub> =100°C	$I_{F(AV)}$	25							A
Peak forward surge current 8.3ms single half-sine-wav superimposed on rated load	$I_{FSM}$	300							A
I <sup>2</sup> t Rating for fusing @T <sub>j</sub> =25°C	I <sup>2</sup> t	373							A <sup>2</sup> S

### Thermal Characteristics

Characteristic	Symbol	GBU25A	GBU25B	GBU25D	GBU25G	GBU25J	GBU25K	GBU25M	UNITS	
Typical junction capacitance per leg (note 3)	$C_J$	211				94				p F
Typical thermal resistance per leg (note 2) (note 1)	$R_{\theta JA}$ $R_{\theta JC}$	2.2 7.0								°C/W
Operating junction temperature range	$T_J$	- 55 ---- + 150							°C	
Storage temperature range	$T_{STG}$	- 55 ---- + 150							°C	

### Electrical Characteristics (@TA = 25°C unless otherwise specified)

Characteristic	Symbol	GBU25A	GBU25B	GBU25D	GBU25G	GBU25J	GBU25K	GBU25M	UNITS
Maximum instantaneous forward voltage @12.5A	$V_F$	1.1							V
Maximum reverse current @T <sub>A</sub> =25°C at rated DC blocking voltage @T <sub>A</sub> =125°C	$I_R$	5.0 500							μ A

NOTE: 1. Unit case mounted on 3.2x3.2x0.12" thick (6.2x8.2x0.3cm) Al. Plate

2. Units mounted in free air, no heat sink on P.C.B., 0.5x0.5"(12x12mm) copper pads, 0.375"(9.5mm) lead length.

3. Measured at 1.0 MHz and applied reverse voltage of 4.0 volts.

**FIG.1 – DERATING CURVE FOR OUTPUT RECTIFIED CURRENT**

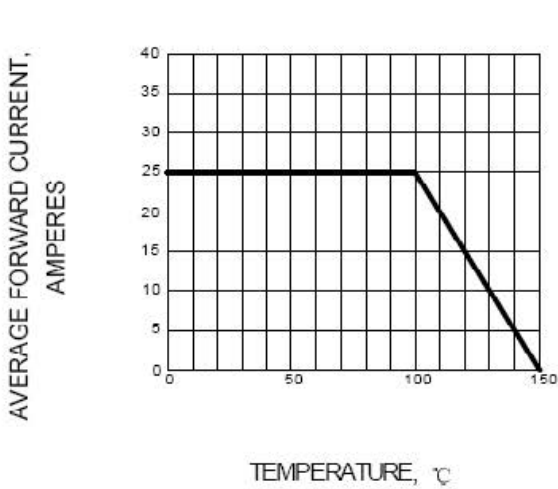

**FIG.2 – TYPICAL FORWARD CHARACTERISTIC**

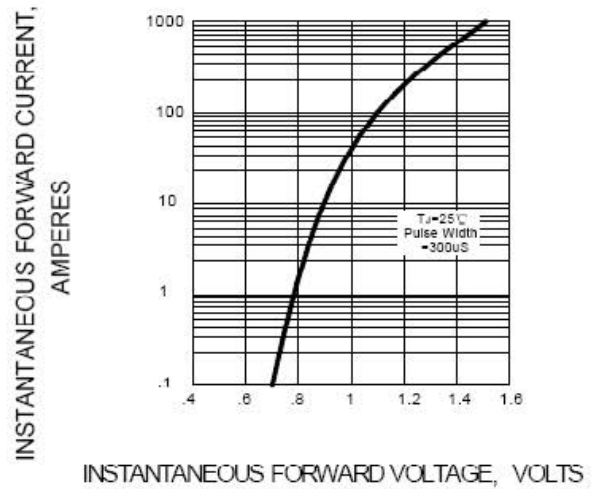

**FIG3: Surge Forward Current Capability**

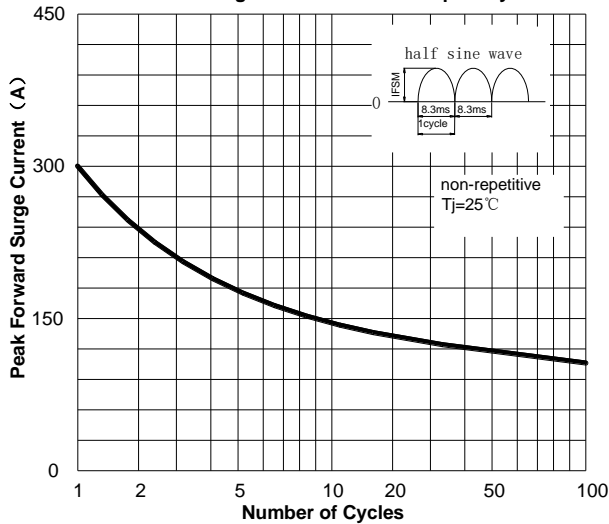

**FIG.4 – TYPICAL REVERSE CHARACTERISTIC**

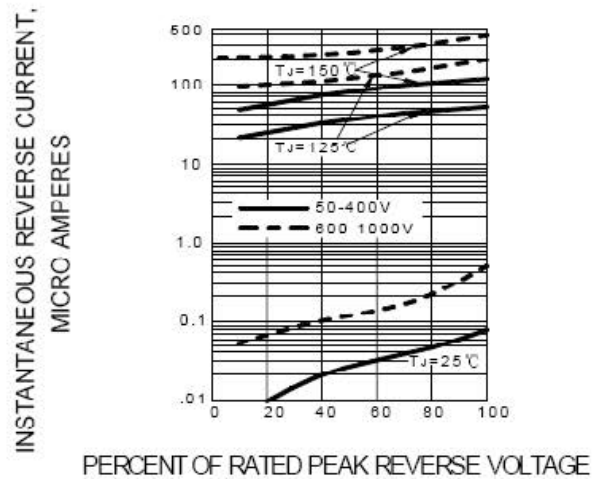

**FIG.5 – TYPICAL JUNCTION CAPACITANCE PER LEG**

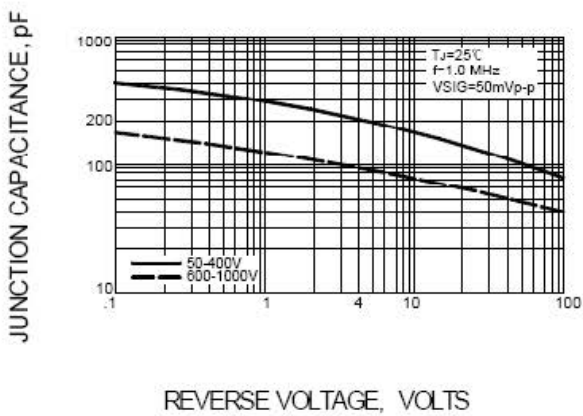

**FIG.6 – TYPICAL TRANSIENT THERMAL IMPEDANCE**

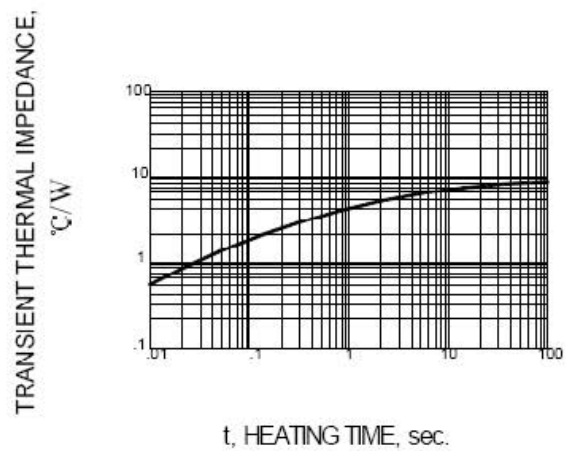

Device	Package	Shipping
GBU25A-GBU25M	GBU	500 Units/Box