

# A1300

10V 2A PNP High-Frequency Low  $V_{ce(sat)}$  Transistor

## 1. Description

- SOT-23-3L High-frequency low  $V_{CE(sat)}$  PNP Transistors

## 2. Features

- High DC Current Gain and Excellent Frequency Performance;
- Low Saturation Voltage

## 3. Application

- Strobe flash, medium power amplifier applications.

## 4. MAXIMUM RATINGS ( $T_a=25^\circ\text{C}$ unless otherwise noted)

Parameter	Symbol	Value	Unit
Collector-Base Voltage	$V_{CB0}$	-20	V
Collector-Emitter Voltage	$V_{CE0}$	-10	V
Emitter-Base Voltage	$V_{EB0}$	-6	V
Collector Current	$I_C$	-2	A
Collector Power Dissipation	$P_C$	750	mW
Junction Temperature	$T_j$	150	$^\circ\text{C}$
Storage Temperature	$T_{stg}$	-55~+150	$^\circ\text{C}$

## 5. Pinning information

Pin	Symbol	Description	Simplified outline	Equivalent Circuit	Marking	Package
1	B	BASE			J11.	SOT-23-3
2	E	EMITTER				
3	C	COLLECTOR				

### 6. Electrical Characteristics (Ta=25 unless otherwise specified)

Symbol	Parameter	Condition	Min	Typ	Max	Unit
$V_{(BR)CBO}$	Collector-base breakdown voltage	$I_C=-1mA, I_E=0$	-20	—	—	V
$V_{(BR)CEO}$	Collector-emitter breakdown voltage	$I_C=-10mA, I_B=0$	-10	—	—	V
$V_{(BR)EBO}$	Emitter-base breakdown voltage	$I_E=-1mA, I_C=0$	-6	—	—	V
$I_{CBO}$	Collector cut-off current	$V_{CB}=-20V, I_E=0$	—	—	-0.1	$\mu A$
$I_{CEO}$	Collector cut-off current	$V_{CE}=-10V, I_B=0$	—	—	-0.1	$\mu A$
$I_{EBO}$	Emitter cut-off current	$V_{EB}=-6V, I_C=0$	—	—	-0.1	$\mu A$
$h_{FE(1)}$	DC current gain	$V_{CE}=-1V, I_C=-500mA$	140	—	600	—
$h_{FE(2)}$		$V_{CE}=-1V, I_C=-4A$	60	120	—	—
$V_{CE(sat)}$	Collector-emitter saturation voltage	$I_C=-2A, I_B=-50mA$	—	-0.2	-0.5	V
$V_{BE}$	Base-emitter voltage	$I_C=-2A, V_{CE}=-1V$	—	-0.83	-1.5	V
$f_T$	Transition frequency	$V_{CE}=-1V, I_C=-0.5A$	140	—	—	MHz
$C_{ob}$	Capacitance	$V_{CB}=-10V, I_E=0, f=1MHz$	—	50	—	pF

### 7. Outline Drawing

SOT-23-3 Package Outline Dimensions

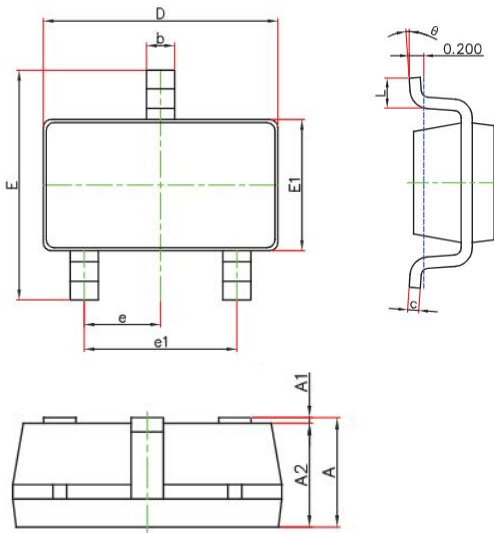

Symbol	Dimensions In Millimeters		Dimensions In Inches	
	Min.	Max.	Min.	Max.
A	1.050	1.250	0.041	0.049
A1	0.000	0.100	0.000	0.004
A2	1.050	1.150	0.041	0.045
b	0.300	0.500	0.012	0.020
c	0.100	0.200	0.004	0.008
D	2.820	3.020	0.111	0.119
E1	1.500	1.700	0.059	0.067
E	2.650	2.950	0.104	0.116
e	0.950(BSC)		0.037(BSC)	
e1	1.800	2.000	0.071	0.079
L	0.300	0.600	0.012	0.024
θ	0°	8°	0°	8°

### 8. Suggested Pad Layout

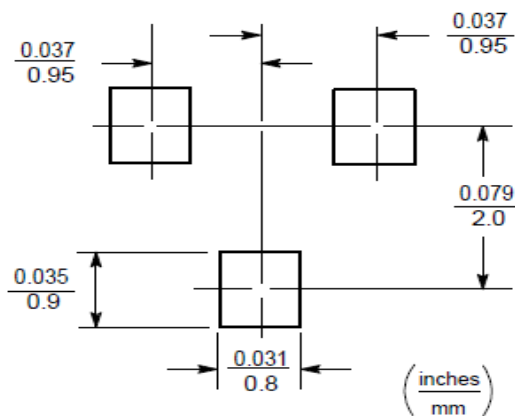

- Note:
1. Controlling dimension: in/millimeters.
  2. General tolerance: ±0.05mm.
  3. The pad layout is for reference purposes only.

### 9.Important Notice and Disclaimer

Microdiode Electronics (Shenzhen) reserves the right to make changes to this document and its products and specifications at any time without notice. Customers should obtain and confirm the latest product information and specifications before final design, purchase or use.

Microdiode Electronics (Shenzhen) makes no warranty, representation or guarantee regarding the suitability of its products for any particular purpose, not does Microdiode Electronics (Shenzhen) assume any liability for application assistance or customer product design. Microdiode Electronics (Shenzhen) does not warrant or accept any liability with products which are purchased or used for any unintended or unauthorized application.

No license is granted by implication or otherwise under any intellectual property rights of Microdiode Electronics (Shenzhen).

Microdiode Electronics (Shenzhen) products are not authorized for use as critical components in life support devices or systems without express written approval of Microdiode Electronics (Shenzhen).